

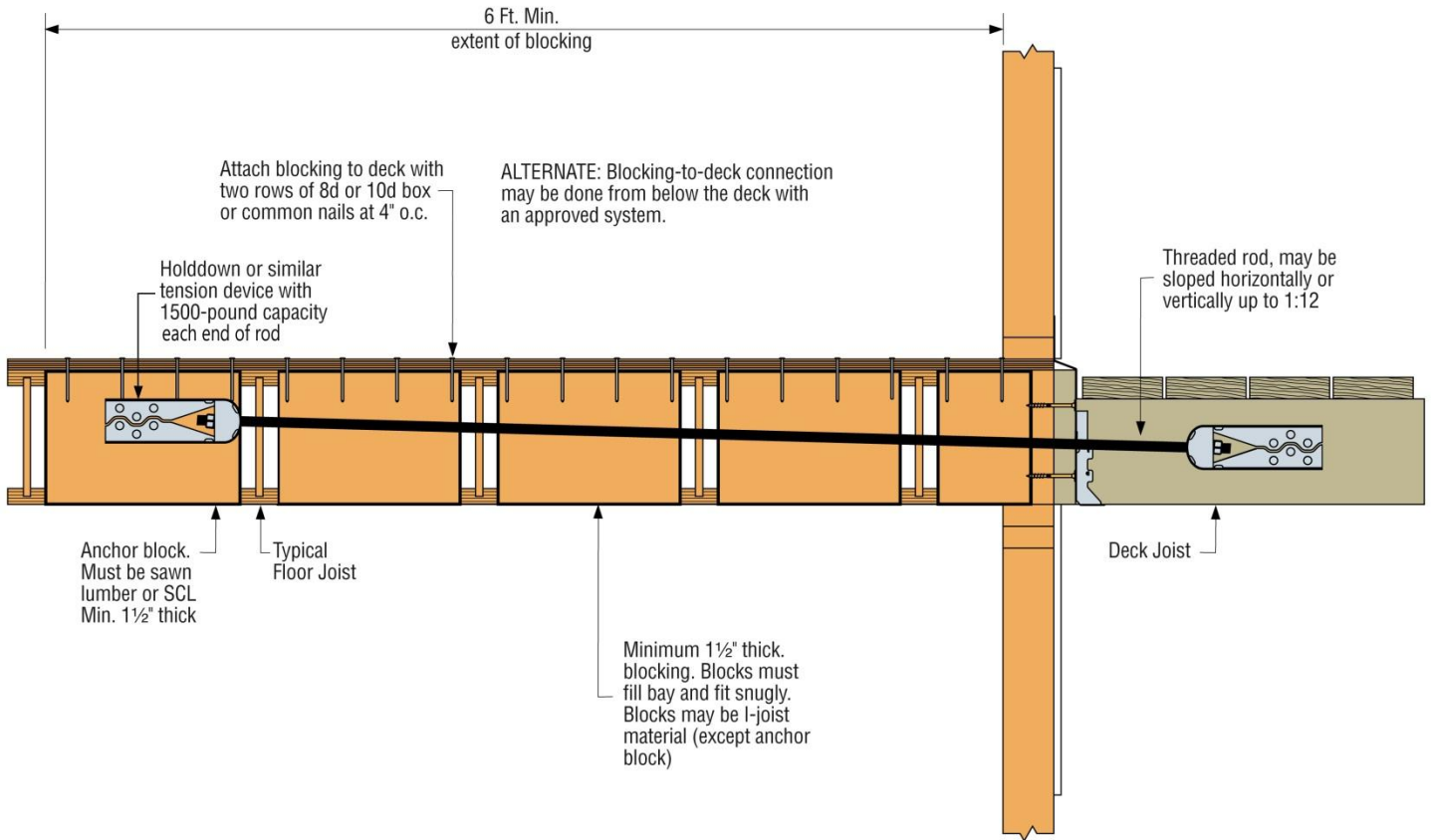

Deck Lateral Load Connection to Prefabricated Wood I-Joist Floor System

The International Residential Code (IRC) includes provisions for resisting lateral forces of an exterior deck that is attached to a structure. Specifically, 2009 IRC R502.2.2.3 and 2012 IRC R507.2.3 require connections at two locations that resist a minimum lateral load of 1500 lbs per connection.

The following two details show methods of properly connecting the deck to Prefabricated Wood I-Joists that are oriented either perpendicular or parallel to the deck framing:



Deck Framing Perpendicular to I-Joist Floor Framing



Deck Lateral Load Connection to Prefabricated Wood I-Joist Floor System (cont.)

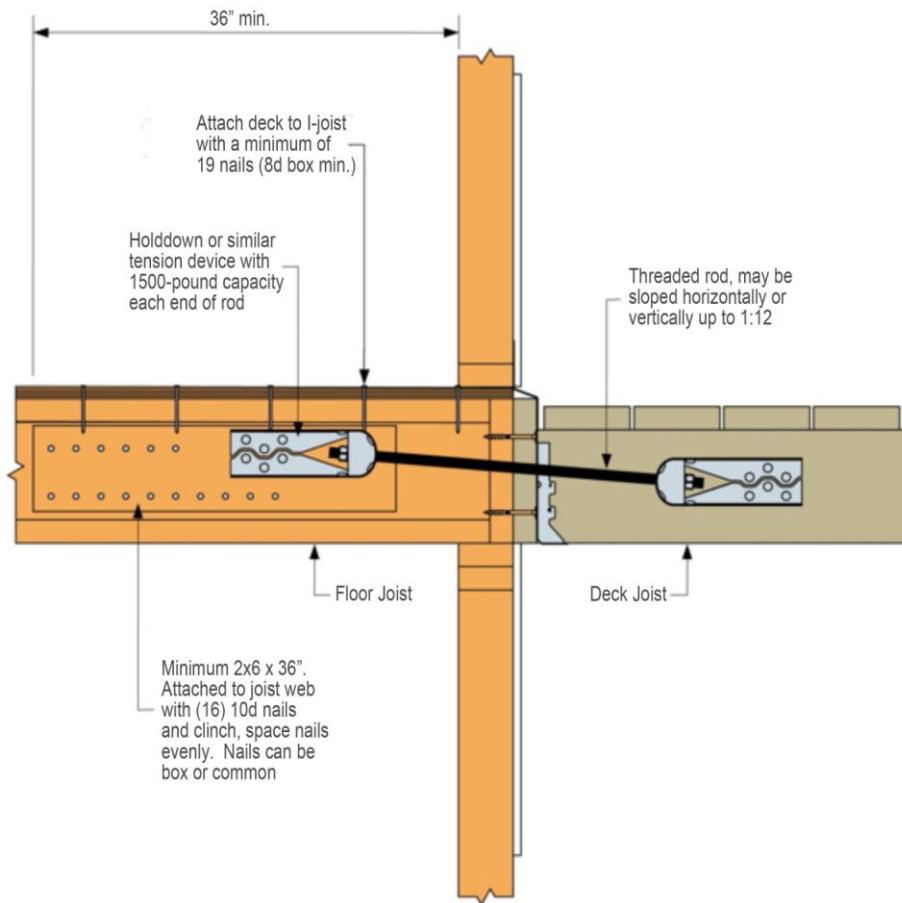

Deck Framing Parallel to I-Joist Floor Framing